

STEP BLOCKS & CLAMPS

1018 STEEL & 11217 STEEL, CASE HARDENED, BLACK OXIDE FINISH

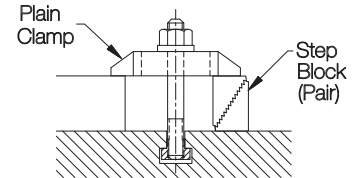

Step Blocks (pair)

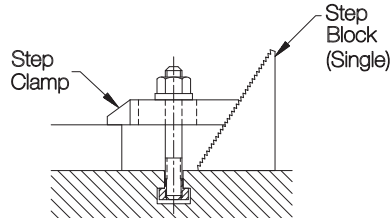

Serrated block that can be used individually or in pairs, as a clamp rest. (One part number consists of a pair of blocks). Use a single block with Step Clamps, or a pair of blocks with Plain Clamps. All blocks and clamps are made from top-grade steel.

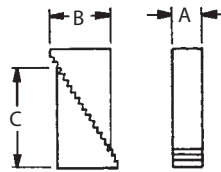

STEP BLOCKS (PAIR)

PART NO.	A	B	C	HEIGHT RANGE
CL-10-BS	1	.681	1.104	3/4 to 1-1/2
CL-20-BS		1.068	1.747	1-1/8 to 2-1/2
CL-30-BS		2.355	3.980	2-1/2 to 6
CL-40-BS	1-1/2	1.454	2.390	1-3/4 to 3-3/4
CL-50-BS		2.355	3.890	2-1/2 to 6
CL-60-BS		3.385	5.604	3-1/2 to 9
CL-80-BS	2	2.355	3.890	2-1/2 to 6
CL-90-BS		3.385	5.604	3-1/2 to 9

7



Step Clamp

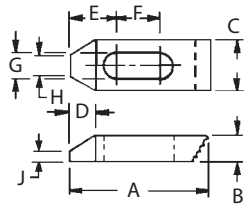

STEP CLAMPS

PART NO.	STUD SIZE	A	B	C	D	E	F	G	H	J
CL-32-STC	3/8 or M10	2-1/2	1/2	1	7/16	7/8	13/16	7/16	7/16	1/4
CL-34-STC		4	5/8		11/16	1-3/16	1-5/16		1/4	
CL-36-STC		6	3/4	1-1/8	3/4	1-1/8	2-3/16	3/8	5/16	
CL-42-STC	1/2 or M12	2-1/2	1/2	1-1/8	7/16	29/32	11/16	9/16	9/16	3/16
CL-44-STC		4	3/4	1-1/4	11/16	1-7/32	1-3/16		1/2	1/4
CL-46-STC		6	7/8		3/4	1-5/32	2-1/8	7/16	5/16	
CL-52-STC	5/8 or M16	2-1/2	5/8	1-1/4	3/8	15/16	9/16	11/16	3/4	3/8
CL-54-STC		4	3/4	1-1/2	11/16	1-1/4	1-1/16		11/16	
CL-56-STC		6	7/8		3/4	1-9/32	1-15/16	9/16	7/16	
CL-64-STC	3/4 or M20	4	3/4	1-1/2	3/4	1-5/16	15/16	13/16	5/8	5/16
CL-66-STC		6	1	1-1/2	13/16	1-1/4	1-7/8		1/2	
CL-68-STC		8		1-3/4	3/4	1-7/8	2-3/16	3/4	5/8	



Plain Clamp

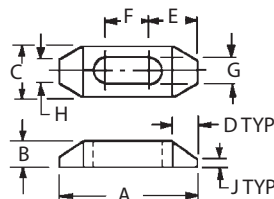

PLAIN CLAMPS

PART NO.	STUD SIZE	A	B	C	D	E	F	G	H	J
CL-32-PC	3/8 or M10	2-1/2	1/2	1	7/16	27/32	13/16	7/16	7/16	1/4
CL-34-PC		4	5/8		11/16	1-1/32	1-7/16		1/4	
CL-36-PC		6	3/4	1-1/8	3/4	1-5/32	2-3/16	3/8	5/16	
CL-42-PC	1/2 or M12	2-1/2	1/2	1-1/8	7/16	29/32	11/16	9/16	9/16	3/16
CL-44-PC		4	3/4	1-1/4	11/16	1-5/32	1-5/16		1/2	1/4
CL-46-PC		6	7/8		3/4	1-9/32	2-1/16	7/16	5/16	
CL-52-PC	5/8 or M16	2-1/2	5/8	1-1/4	3/8	31/32	9/16	11/16	3/4	3/8
CL-54-PC		4	3/4	1-1/2	11/16	1-9/32	1-3/16		11/16	
CL-56-PC		6	7/8	1-1/2	3/4	1-13/32	1-15/16	9/16	7/16	
CL-64-PC	3/4 or M20	4	3/4	1-1/2	3/4	1-11/32	1-1/16	13/16	5/8	5/16
CL-66-PC		6	1	1-1/2	13/16	1-15/32	1-15/16		1/2	
CL-68-PC		8	1-1/8	1-3/4	3/4	1-29/32	2-3/16	3/4	5/8	