

TAPPED-HEEL CLAMP STRAPS

STEEL: 1018, CASE HARDENED, BLACK OXIDE FINISH
 STAINLESS STEEL: 300 SERIES



Steel and Stainless Steel

Popular Clamp Strap with a tapped heel that accepts a clamping screw or rear support. Often used with a Guide Block to allow sliding the strap straight back for clear loading. Two drill spots on the sides provide a secure grip for retracting the clamp. **INFO+:** Can also be used with a Stud Leveling Foot as a rear support.

Available in steel for 1/4-20 to 3/4-10 stud sizes (M6 to M20 in metric), or stainless steel for #10-32 to 3/8-16 stud sizes. Each size is available in several strap lengths.

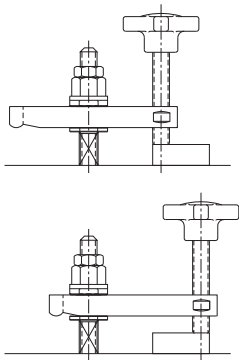

INFO+: See pages 254-257 for complete assemblies using these Clamp Straps.

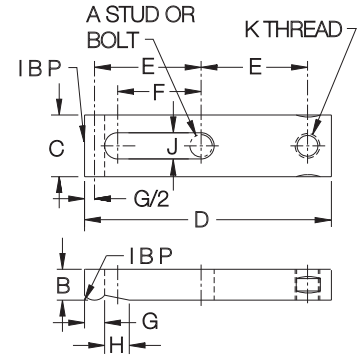

STRAPS — STEEL (INCH)

PART NO.	A	B	C	D	E	F	G	H	J	K
CL-61-CS	1/4-20	3/8	5/8	2	13/16	9/16	1/4	11/32	9/32	1/4-20
CL-62-CS				2-1/2	1-1/16	13/16				
CL-63-CS	3/8-16	1/2	1-1/8	3	1-7/32	13/16	13/32	1/2	27/64	3/8-16
CL-65-CS				4	1-23/32	1-5/16				
CL-67-CS				5	2-7/32	1-13/16				
CL-69-CS				6	2-23/32	2-5/16				
CL-70-CS	1/2-13	5/8	1-1/4	3-1/2	1-13/32	15/16	13/32	1/2	17/32	1/2-13
CL-71-CS				4	1-21/32	1-3/16				
CL-72-CS				4-1/2	1-29/32	1-7/16				
CL-73-CS				5	2-5/32	1-11/16				
CL-74-CS	5/8-11	7/8	1-1/2	5-1/2	2-13/32	1-15/16	1/2	19/32	21/32	5/8-11
CL-75-CS				6	2-21/32	2-3/16				
CL-81-CS				4	1-9/16	1				
CL-77-CS				4-1/2	1-13/16	1-1/4				
CL-83-CS	3/4-10	1	1-3/4	5	2-1/16	1-1/2	1/2	19/32	13/16	3/4-10
CL-85-CS				6	2-9/16	2				
CL-86-CS				6-1/2	2-13/16	2-1/4				
CL-88-CS	3/4-10	1	1-3/4	6	2-1/2	1-29/32	1/2	19/32	13/16	3/4-10
CL-90-CS				7	3	2-13/32				
CL-92-CS				8	3-1/2	2-29/32				

STRAPS — STEEL (METRIC)

PART NO.	A STUD SIZE	B (mm)	C (mm)	D (mm)	E (mm)	F (mm)	G (mm)	H (mm)	J (mm)	K THREAD	THREAD PITCH (mm)
CLM-61-CS	M6	9.5	16	51	20.5	14.5	6.5	8.5	7	M6	1
CLM-62-CS	M6	9.5	16	63	27	20.5	6.5	8.5	7	M6	1
CLM-63-CS	M10	12.5	28.5	76	31	20.5	10.5	12.5	10.5	M10	1.5
CLM-65-CS	M10	12.5	28.5	101.5	43.5	33.5	10.5	12.5	10.5	M10	1.5
CLM-67-CS	M10	12.5	28.5	127	56.5	46	10.5	12.5	10.5	M10	1.5
CLM-70-CS	M12	16	32	89	35.5	24	10.5	12.5	13.5	M12	1.75
CLM-71-CS	M12	16	32	101.5	42	30	10.5	12.5	13.5	M12	1.75
CLM-72-CS	M12	16	32	114	48.5	36.5	10.5	12.5	13.5	M12	1.75
CLM-73-CS	M12	16	32	127	55	43	10.5	12.5	13.5	M12	1.75
CLM-75-CS	M12	16	32	162	67.5	55.5	10.5	12.5	13.5	M12	1.75
CLM-81-CS	M16	22	38	101.5	39.5	25.5	12.5	15	16.5	M16	2
CLM-83-CS	M16	22	38	127	52.5	38	12.5	15	16.5	M16	2
CLM-85-CS	M16	22	38	152	65	51	12.5	15	16.5	M16	2
CLM-88-CS	M20	25.5	44.5	152	63.5	48.5	12.5	15	20.5	M20	2.5
CLM-92-CS	M20	25.5	44.5	203	89	74	12.5	15	20.5	M20	2.5

STRAPS — STAINLESS STEEL (INCH)

PART NO.	A	B	C	D	E	F	G	H	J	K
CL-18215	#10-32	1/4	1/2	1-1/2	19/32	13/32	3/16	5/16	7/32	#10-32
CL-18220				2	27/32	21/32				
CL-18320	1/4-20	3/8	5/8	2	13/16	19/32	1/4	3/8	9/32	1/4-20
CL-18325				2-1/2	1-1/16	27/32				
CL-18540	3/8-16	1/2	1	4	1-23/32	1-3/8	3/8	1/2	27/64	3/8-16