

GRIPPER SWIVEL SCREWS

BODY: STEEL, CASE HARDENED, BLACK OXIDE FINISH
SWIVEL BALL: HIGH-SPEED TOOL STEEL



Hardened Tool Steel (Serrated)



Hardened Tool Steel (Flat)

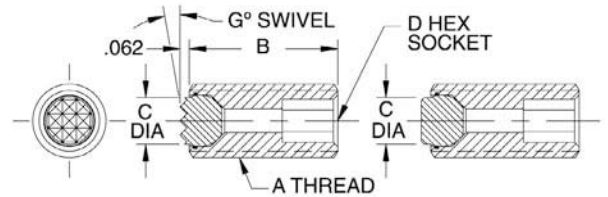

Screw clamp with a hardened tool steel swivel ball, either serrated or flat. A positive stop prevents the ball from swiveling too far. Serrated grippers are designed to slightly penetrate the workpiece to significantly increase gripping force, rather than relying on static friction alone. Available in thread sizes from 3/8-16 to 5/8-11 (M10 to M16 in metric) each in a choice of several lengths.

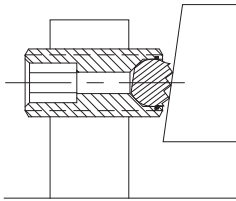

COMPLETE ASSEMBLY (INCH)

PART NO. — COMPLETE		A	B	C DIA	D	G	SERRATIONS		
HARDENED TOOL STEEL (SERRATED)	HARDENED TOOL STEEL (FLAT)						Super Fine		
CL-605-GSS	CL-605-GSF	3/8-16	1/2	5/32	3/16	14°	Super Fine	.062x90°	
CL-610-GSS	CL-610-GSF		1						
CL-620-GSS	CL-620-GSF		2						
CL-810-GSS	CL-810-GSF	1/2-13	1	1/4	1/4		Extra Fine	.094x90°	
CL-820-GSS	CL-820-GSF		2						
CL-830-GSS	CL-830-GSF		3						
CL-1010-GSS	CL-1010-GSF	5/8-11	1	5/16	5/16				
CL-1020-GSS	CL-1020-GSF		2						
CL-1030-GSS	CL-1030-GSF		3						

COMPLETE ASSEMBLY (METRIC)

PART NO. — COMPLETE		A	B	C DIA	D	G	SERRATIONS	
CLM-XXXX-GSS	CLM-XXXX-GSF						Super Fine	
CLM-1025-GSS	CLM-1025-GSF	M10	.98	.16	5mm	15°	Super Fine	.062x90°
CLM-1050-GSS	CLM-1050-GSF		1.97					
CLM-1225-GSS	CLM-1225-GSF	M12	.98	.24	6mm	14°	Extra Fine	.094x90°
CLM-1250-GSS	CLM-1250-GSF		1.97					
CLM-1625-GSS	CLM-1625-GSF	M16	.98	.33	8mm	12°	Extra Fine	.094x90°
CLM-1650-GSS	CLM-1650-GSF		1.97					

ROUND CARBIDE PADS

SOLID CARBIDE

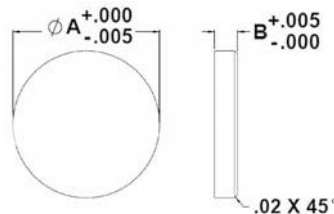

These handy round pads are made from solid carbide for high wear resistance. Pads can be brazed or bonded to install. The bottom is slightly chamfered for clearance in a mounting bracket. Available in diameters from 1/4 to 1". Made in USA.

PART NO.	A	B
CL-4-RCP	1/4	1/8
CL-5-RCP	5/16	1/8
CL-6-RCP	3/8	1/8
CL-8-RCP	1/2	1/8
CL-10-RCP	5/8	1/8
CL-12-RCP	3/4	1/8
CL-16-RCP	1	5/32