

OVAL TAPERED KNOBS

BLACK PHENOLIC OR CUSHION-GRIP PLASTIC WITH BRASS INSERT

Phenolic — Tapped



3/8-16 CL-66-PTK
1/2-13 CL-68-PTK
M10 CLM-610-PTK
M12 CLM-612-PTK

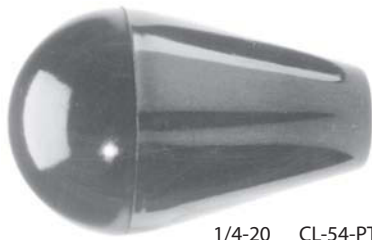

1/4-20 CL-54-PTK
5/16-18 CL-55-PTK
M8 CLM-58-PTK



1/4-20 CL-44-PTK
5/16-18 CL-45-PTK
3/8-16 CL-46-PTK
M6 CLM-46-PTK



#10-32 CL-23-PTK
1/4-20 CL-24-PTK
M6 CLM-26-PTK

Cushion Grip — Tapped

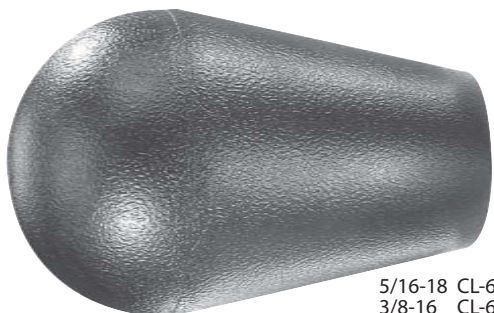

5/16-18 CL-650-PTK
3/8-16 CL-660-PTK

Phenolic — Through Hole

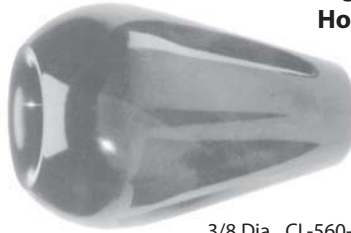

3/8 Dia CL-560-PTK

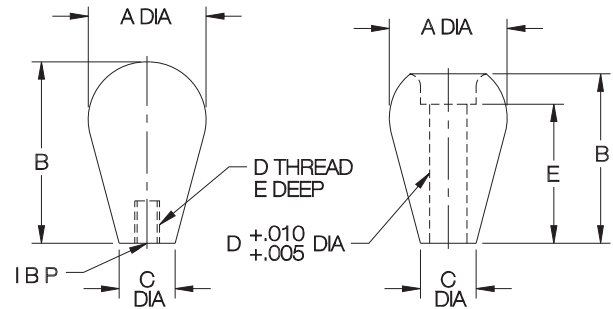

Oval Tapered Knob



Attractive design suitable for control levers and push/pull rods. Molded-in brass insert provides superior thread strength. The solid-plastic through-hole version can be used with a Shoulder Screw as a revolving crank handle. Choice of four knob sizes. Non-standard thread sizes, molded-in studs, or special colors (cushion grip only) are available in quantities of 500 and above.

PHENOLIC — TAPPED (INCH)

PART NO.	A DIA	B	C DIA	D THREAD	E
CL-23-PTK	3/4	1-1/4	3/8	#10-32	5/16
CL-24-PTK*				1/4-20	7/16
CL-44-PTK	1	1-5/8	1/2	1/4-20	7/16
CL-45-PTK				5/16-18	7/16
CL-46-PTK				3/8-16	1/2
CL-54-PTK	1-3/16	1-7/8	9/16	1/4-20	7/16
CL-55-PTK				5/16-18	13/16
CL-66-PTK	1-5/8	2-1/2	7/8	3/8-16	1/2
CL-68-PTK				1/2-13	5/8

PHENOLIC — THROUGH HOLE (INCH)

CL-560-PTK*	1-3/16	1-3/4	9/16	.375	1-7/16
-------------	--------	-------	------	------	--------

CUSHION GRIP — TAPPED (INCH)

CL-650-PTK	1-5/8	2-1/2	7/8	5/16-18	5/8
CL-660-PTK				3/8-16	

PHENOLIC — TAPPED (METRIC)

PART NO.	A DIA (mm)	B (mm)	C DIA (mm)	D THREAD	THREAD PITCH (mm)	E (mm)
CLM-26-PTK*	19	32	10	M6	1	11
CLM-46-PTK	25.5	41	12.5	M6	1	10
CLM-58-PTK	30	48	14	M8	1.25	19
CLM-610-PTK	41	64	22	M10	1.5	13
CLM-612-PTK	41	64	22	M12	1.75	16

* These sizes are solid plastic, without a brass insert.