

ADJUSTABLE HANDLES

HANDLE: FIBER-REINFORCED THERMOPLASTIC WITH STAINLESS STEEL INSERT
BODY, SCREW, AND SPRING: STEEL, BLACK OXIDE FINISH

Steel Body
Plastic Handle (Black)

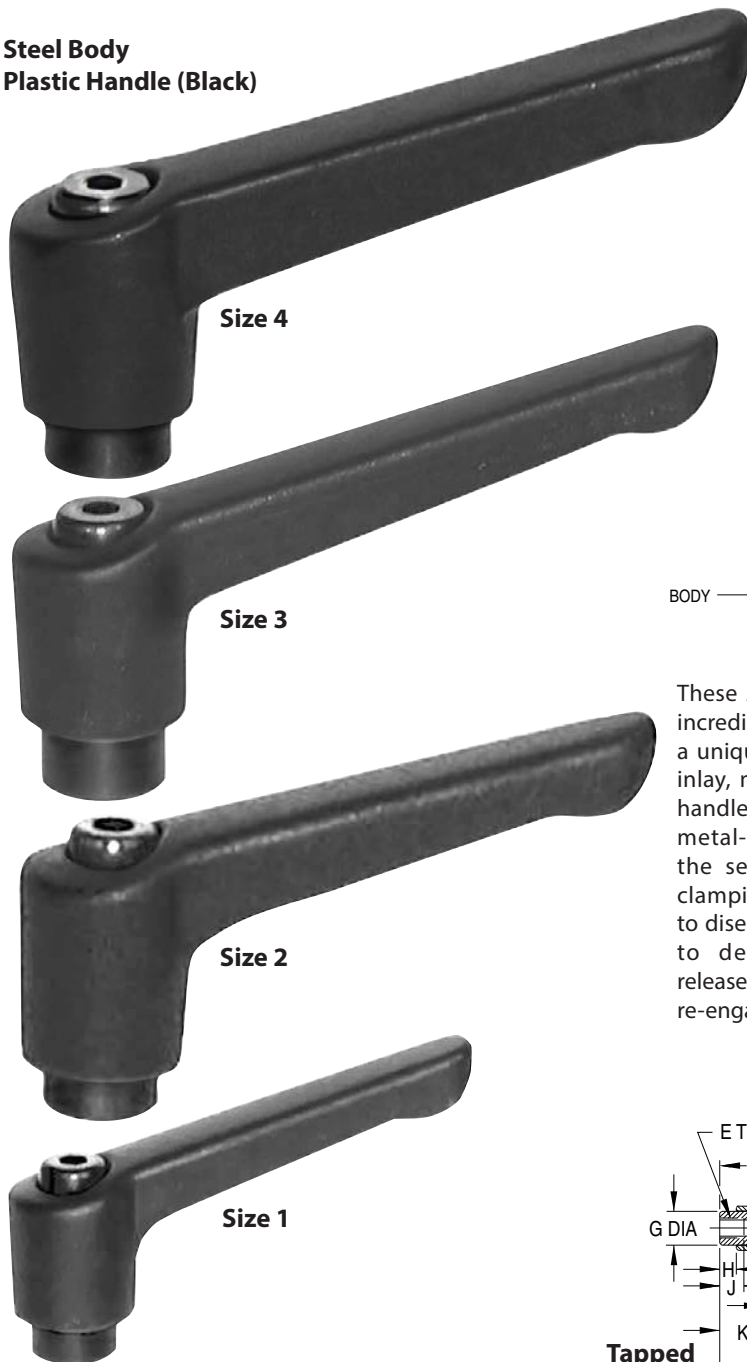

Size 4

Size 3

Size 2

Size 1

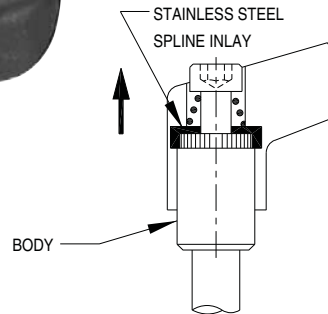

These Adjustable Handles are incredibly strong! They feature a unique stainless steel spline inlay, molded into the plastic handle. This provides positive metal-to-metal mating with the serrated body, for high clamping torque. Lift handle to disengage serrations, rotate to desired position, then release handle to automatically re-engage spline.

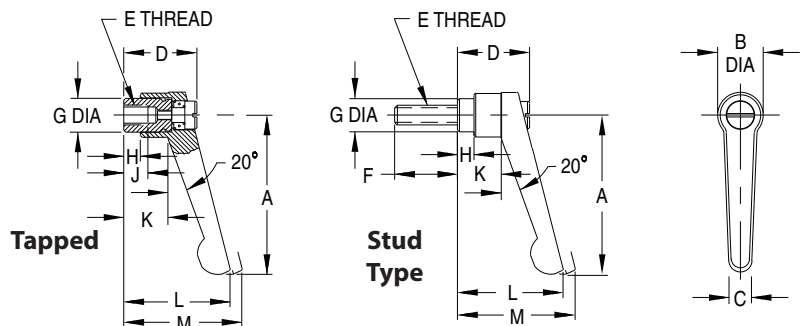

Stud Type

Adjustable handle that can be reset to any angle. Ideal for clamping in a confined space, or when a specific handle position is desired. Available in steel (with a black plastic handle) or stainless steel (with a metallic-gray plastic handle, **INFO+** see page 136). Rugged spring-loaded spline mechanism. Choice of four handle sizes. Available with a tapped hole or with an integral stud.

TAPPED (INCH)

PART NO. STEEL BLACK	SIZE	E	J
CL-3-AHP-1	1	#10-32	.31
CL-4-AHP-1		1/4-20	
CL-4-AHP-2	2	1/4-20	.39
CL-5-AHP-2		5/16-18	
CL-5-AHP-3	3	5/16-18	.55
CL-6-AHP-3		3/8-16	
CL-6-AHP-4	4	3/8-16	.67

TAPPED (METRIC)

CLM-8-AHP-2	2	M8	.39
CLM-12-AHP-4	4	M12	.67

STUD TYPE (INCH)

PART NO. STEEL BLACK	SIZE	E	F
CL-408-AHP-1	1	1/4-20	.78
CL-416-AHP-1			1.57
CL-508-AHP-2	2	5/16-18	.78
CL-516-AHP-2			1.57
CL-525-AHP-2			2.48
CL-610-AHP-3	3	3/8-16	.98
CL-616-AHP-3			1.57
CL-625-AHP-3	4	1/2-13	2.48
CL-816-AHP-4			1.57
CL-825-AHP-4			2.48

STUD TYPE (METRIC)

CLM-620-AHP-1	1	M6	20mm
CLM-640-AHP-1			40mm
CLM-820-AHP-2	2	M8	20mm
CLM-840-AHP-2			40mm
CLM-1030-AHP-3	3	M10	32mm
CLM-1050-AHP-3			50mm

GENERAL DIMENSIONS

SIZE	A	B DIA	C	D	G DIA	H	K	L	M
1	1-3/4	19/32	5/16	31/32	3/8	5/32	7/16	1-3/8	1-1/2
2	2-1/2	3/4	13/32	1-7/32	17/32	1/4	13/16	1-25/32	1-15/16
3	3-1/16	7/8	17/32	1-7/16	5/8	5/16	7/8	2-5/32	2-5/16
4	3-5/8	1	9/16	1-11/16	3/4	7/16	1-3/16	2-9/16	2-23/32