

# ADJUSTABLE HANDLES

HANDLE: ZINC DIE CASTING; ENAMEL PAINT  
 BODY: 1215 STEEL, BLACK OXIDE FINISH. SPRING: MUSIC WIRE

## Steel Body

### Zinc Die Cast Handle (Moss Green)

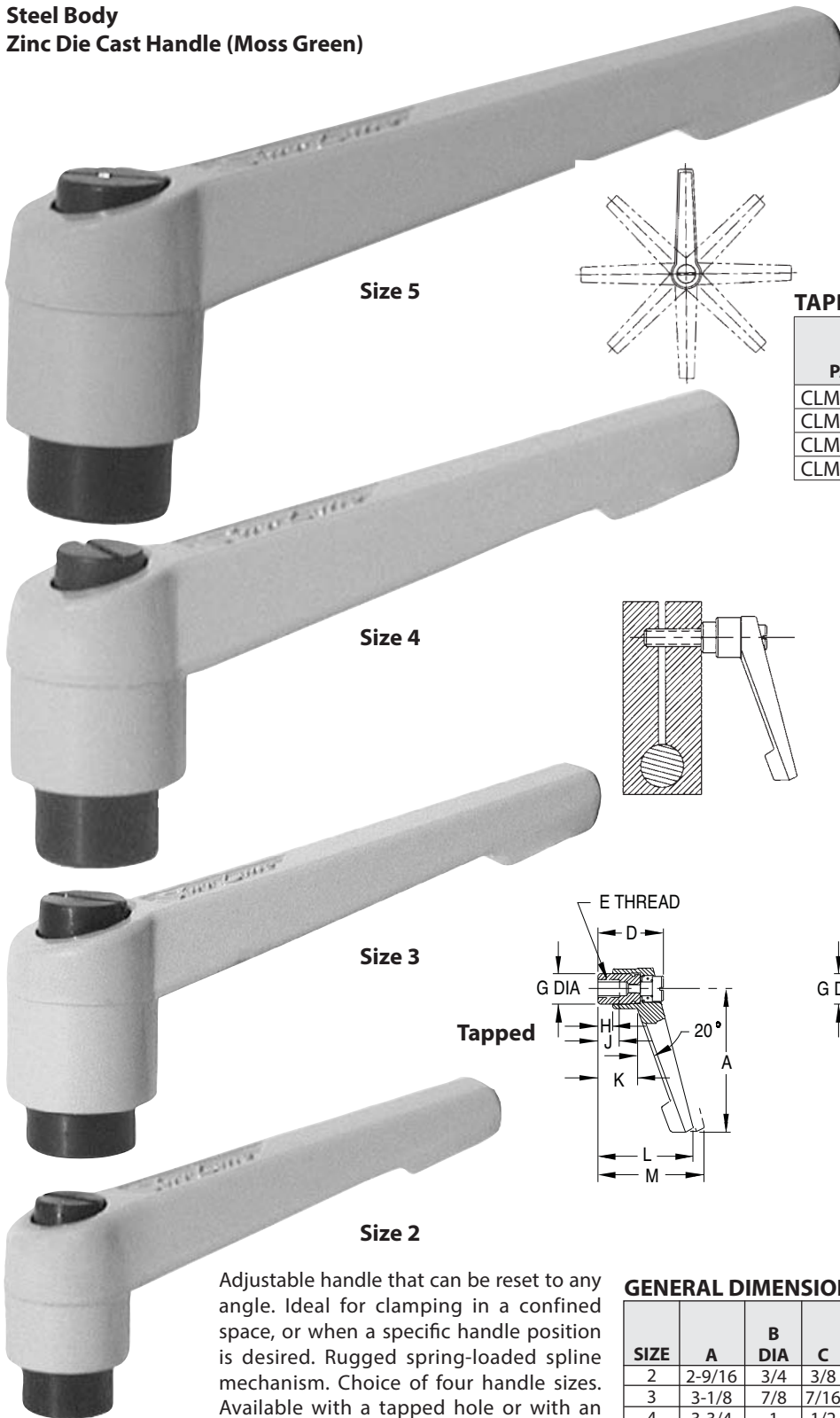

### TAPPED (INCH)

PART NO.	SIZE	E	J
CL-4-AH-2	2	1/4-20	1/2
CL-5-AH-2		5/16-18	
CL-5-AH-3	3	5/16-18	9/16
CL-6-AH-3		3/8-16	
CL-6-AH-4	4	3/8-16	5/8
CL-8-AH-4		1/2-13	
CL-8-AH-5	5	1/2-13	7/8
CL-10-AH-5		5/8-11	

### TAPPED (METRIC)

PART NO.	SIZE	E THREAD	THREAD PITCH (mm)	J (mm)
CLM-8-AH-2	2	M8	1.25	12
CLM-10-AH-3	3	M10	1.5	14
CLM-12-AH-4	4	M12	1.75	16
CLM-16-AH-5	5	M16	2	22

### STUD TYPE (INCH)

PART NO.	SIZE	E	F
CL-510-AH-2	2	5/16-18	1
CL-515-AH-2			1-1/2
CL-520-AH-2			2
CL-610-AH-3	3	3/8-16	1
CL-615-AH-3			1-1/2
CL-620-AH-3	4	1/2-13	2
CL-810-AH-4			1
CL-815-AH-4			1-1/2
CL-820-AH-4			2
CL-830-AH-4	5	5/8-11	3
CL-1015-AH-5			1-1/2
CL-1020-AH-5			2
CL-1030-AH-5			3

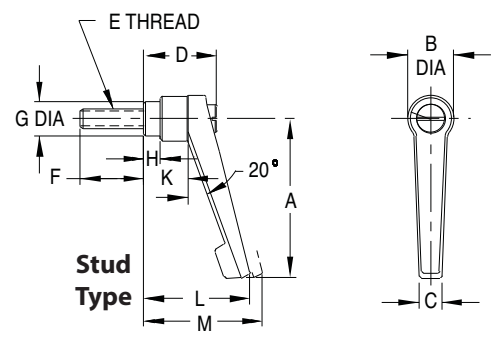
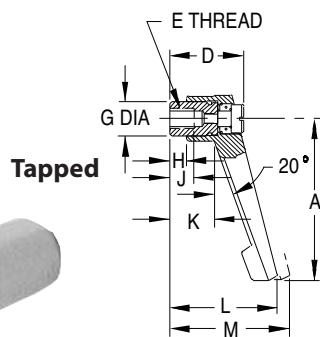

Adjustable handle that can be reset to any angle. Ideal for clamping in a confined space, or when a specific handle position is desired. Rugged spring-loaded spline mechanism. Choice of four handle sizes. Available with a tapped hole or with an integral stud.

### GENERAL DIMENSIONS

SIZE	A	B DIA	C	D	G DIA	H	K	L	M
2	2-9/16	3/4	3/8	1-1/8	17/32	1/4	11/16	1-11/16	1-7/8
3	3-1/8	7/8	7/16	1-1/2	5/8	13/32	15/16	2-3/16	2-5/16
4	3-3/4	1	1/2	1-11/16	3/4	13/32	1-1/16	2-1/2	2-11/16
5	4-5/16	1-1/4	5/8	2	15/16	15/32	1-5/16	2-15/16	3-1/8