

KNURLED KNOBS

STEEL: 1215, CARBURIZED-HARDENED, BLACK OXIDE FINISH.
 STAINLESS STEEL: 300-SERIES, PASSIVATED

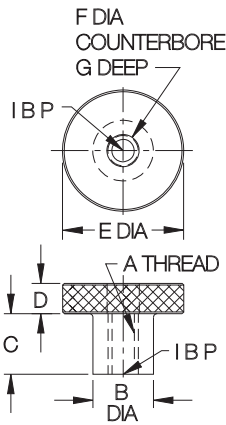

High-quality knurled-head knob provides a positive grip for quick finger tightening in light clamping applications. Available in steel with a black oxide finish or stainless steel.



STEEL (INCH)

PART NO.	A	B DIA	C	D	E DIA	F DIA	G
CL-4-KK	1/4-20	5/8	1/2	1/4	1	NONE	NONE
CL-5-KK	5/16-18	5/8	1/2	5/16	1-1/4		
CL-6-KK	3/8-16	3/4	5/8	1/2	1-1/4		
CL-8-KK	1/2-13	1	3/4	1/2	1-1/2		

STAINLESS STEEL (INCH)

PART NO.	A	B DIA	C	D	E DIA	F DIA	G
CL-16312	#10-24	3/8	1/4	3/16	1/2	NONE	NONE
CL-16322			1/2			13/64	1/4
CL-16314			1/4	3/16	1	NONE	NONE
CL-16324			1/2			13/64	1/4
CL-16412	#10-32	3/8	1/4	3/16	1/2	NONE	NONE
CL-16422			1/2			13/64	1/4
CL-16414			1/4	3/16	1	NONE	NONE
CL-16424			1/2			13/64	1/4
CL-16513	1/4-20	1/2	1/4	1/4	3/4	NONE	NONE
CL-16514			1/4	1/4	1	NONE	NONE
CL-16524			1/2			17/64	1/4
CL-16534			3/4	17/64	1/2		
CL-16625	5/16-18	5/8	1/2	5/16	1-1/4	21/64	1/4
CL-16635			3/4			1/2	
CL-16725	3/8-16	3/4	1/2	3/8	1-1/4	25/64	1/4
CL-16735			3/4			1/2	
CL-8-KK-S	1/2-13	1	3/4	1/2	1-1/2	NONE	NONE

STEEL (METRIC)

PART NO.	A THREAD	THREAD PITCH (mm)	B DIA (mm)	C (mm)	D (mm)	E DIA (mm)	F DIA	G
CLM-5-KK	M5	.8	10	7.5	4	20	None	None
CLM-6-KK	M6	1	12	10	5	24		
CLM-8-KK	M8	1.25	16	12	6	30		
CLM-10-KK	M10	1.5	20	15	8	36		
CLM-12-KK	M12	1.75	20	15	8	40		

STAINLESS STEEL (METRIC)

PART NO.	A THREAD	THREAD PITCH (mm)	B DIA (mm)	C (mm)	D (mm)	E DIA (mm)	F DIA	G
CLM-6-KK-S	M6	1	12	10	5	24	None	None
CLM-10-KK-S	M10	1.5	20	15	8	36		