

# CAPTIVE CLAMPING PINS

KNOB: 8620 STEEL, CASE HARDENED, BLACK OXIDE FINISH  
 PIN BODY: 1215 STEEL, CASE HARDENED, BLACK OXIDE FINISH

1



**Assembly with Knurled Knob**

These Captive Clamping Pins have a knurled knob for tightening by hand and a pin body that is positively retained in a locking bushing. In fully retracted position, the bushing's spring clip snaps into the pin's radial groove. This holds the pin fully retracted by spring force. These pins also incorporate a positive thread stop (the .10"-long unthreaded portion with a square shoulder, above the threads) to positively prevent screwing the pin past the spring clip. Spring pressure also holds the pin in intermediate extended positions, an advantage especially if the fixture is turned upside down. Available in fine-thread sizes from #10-32 to 3/8-24.

These clamping pins must be ordered as three separate items: (1) Knurled Knob with roll pin; (2) Pin Body; (3) Locking-Pin Bushing. The Pin Body must be cut to length and pinned by the customer to suit the specific application (3" maximum A dimension). For dimensions and specifications of Locking-Pin Bushings, see opposite page.

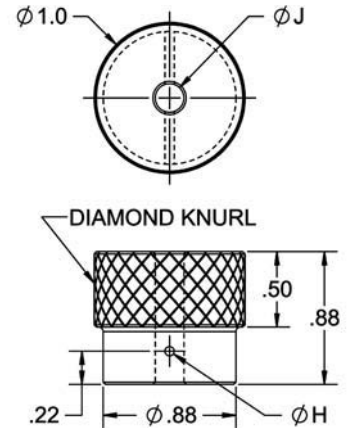

## KNURLED KNOB WITH ROLL PIN (INCH)

PART NO.	KNOB DIA	H DIA	J DIA
CL-190-CPKK	1	1/16	.190
CL-250-CPKK		3/32	.250
CL-313-CPKK		3/32	.313
CL-375-CPKK		1/8	.375

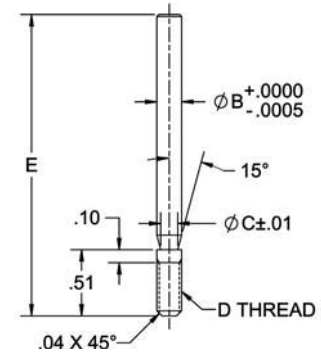
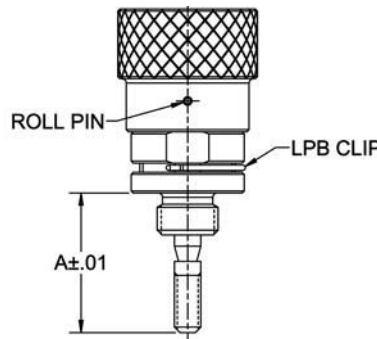
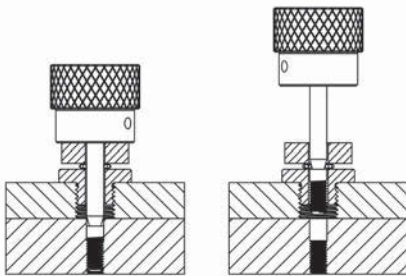

## PIN BODY (INCH)

PART NO.	A MAX	B DIA		C DIA	D THREAD	E
		NOMINAL	ACTUAL			
CL-190-CCPT-3.000	3.000	#10	.1890	.13	#10-32	4.32
CL-250-CCPT-3.000		1/4	.2490	.17	1/4-28	
CL-313-CCPT-3.000		5/16	.3115	.21	5/16-24	
CL-375-CCPT-3.000		3/8	.3740	.26	3/8-24	



**Knurled Knob with Roll Pin**

**Pin Body**

**Locking-Pin Bushing**

## LOCKING-PIN BUSHINGS (INCH)

PART NO. STANDARD PRESS-FIT BUSHING	PART NO. OVERSIZE PRESS-FIT BUSHING	PART NO. OVERSIZE THREADED BUSHING	FOR PIN BODY DIA
—	—	CL-3-TLPB-OS	#10
CL-4-LPB	CL-4-LPB-OS	CL-4-TLPB-OS	1/4
CL-5-LPB	CL-5-LPB-OS	CL-5-TLPB-OS	5/16
CL-6-LPB	CL-6-LPB-OS	CL-6-TLPB-OS	3/8