

SC190 to SC925

Long stroke and soft impact

Self-Compensating, Soft-Contact

Energy capacity 225 in-lbs/Cycle to 975 in-lbs/Cycle

Stroke 0.63 in to 1.58 in

Ideal for soft damping: the SC found in the model code from the ACE product family SC190 to SC925 stands for 'soft contact'. These miniature shock absorbers manufactured from one solid piece are designed in such a way that they can be setup with a linear or a progressive braking curve. The soft damping character is thanks to the special, long strokes which produce smooth deceleration and low reaction forces.

These maintenance-free, ready-to-install hydraulic machine elements are equipped with an integrated positive stop. The use of side load adapter allows impact angles of up to 25°. Thanks to the designed overlapping effective weight ranges, these dampers cover an effective load range of 3 lbs. to 4,400 lbs! Self-compensating shock absorbers react to changing energy conditions, without adjustment.

These miniature self-compensating shock absorbers from the SC190 to SC925 product family are used in industrial, automation and machine engineering and primarily in the areas of handling and automation.

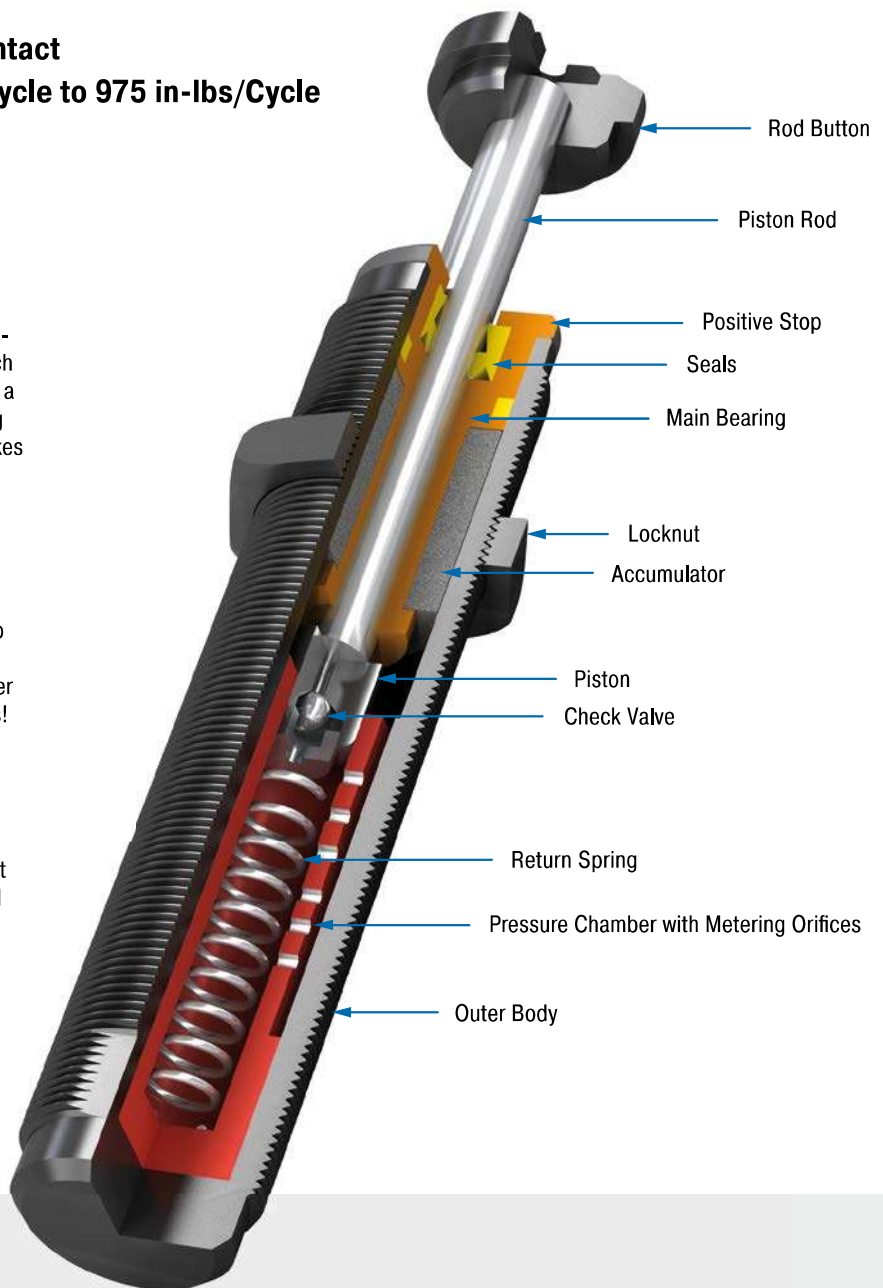

Technical Data

Energy capacity: 225 in-lbs/Cycle to 975 in-lbs/Cycle

Impact velocity range: 0.5 ft/sec to 12 ft/sec. Other speeds on request.

Operating temperature range: 32 °F to 150 °F

Mounting: In any position

Positive stop: Integrated

Material: Outer body, Accessories: Steel corrosion-resistant coating; Piston rod: Hardened stainless steel

Damping medium: Oil, temperature stable

Application field: Linear slides, Pneumatic

plants, Finishing and processing centers, Measuring tables, Tool machines

Note: If precise end position data is required consider use of a stop collar.

Safety information: External materials in the surrounding area can attack the seal components and lead to a shorter service life. Please contact ACE for appropriate solution suggestions. Do not paint the shock absorbers due to heat emission.

On request: Nickel-plated or weartec finish (seawater resistant) or other special finishes available to special order. Models without rod end button.

SC190; 0 to 4

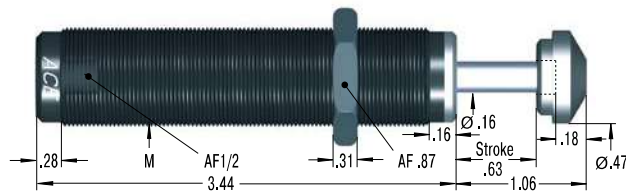

Product available for UNF and metric thread (for metric add suffix -M from part number)

250-0318 Mounting Block

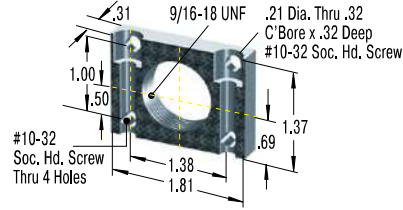

250-0352 Mounting Block

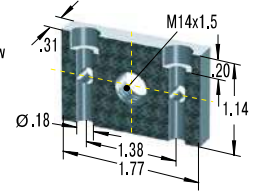

SC300; 0 to 4

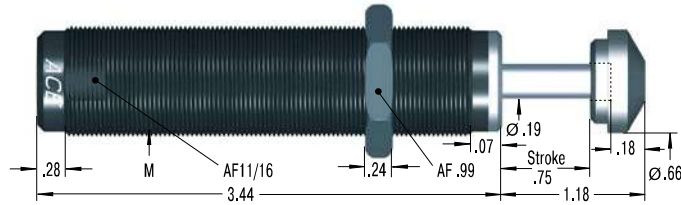

Product available for UNF and metric thread (for metric add suffix -M from part number)

250-0401 Mounting Block

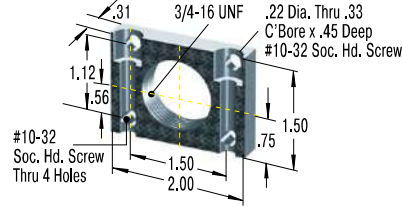

250-0353 Mounting Block

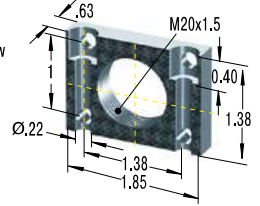

SC650; 0 to 4

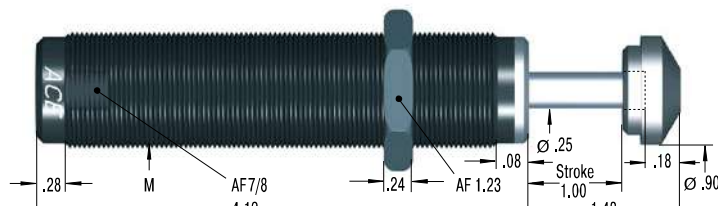

Product available for UNF and metric thread (for metric add suffix -M from part number)

250-0402 Mounting Block

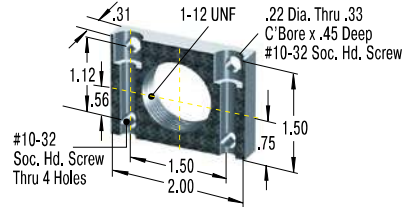

250-0044 Mounting Block

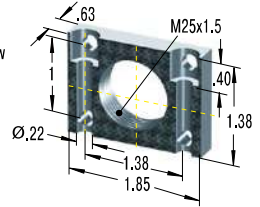

SC925; 0 to 4

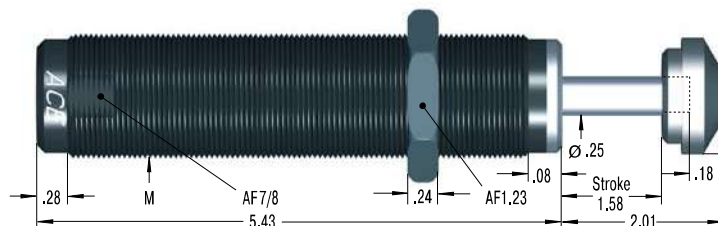

Product available for UNF and metric thread (for metric add suffix -M from part number)

250-0402 Mounting Block

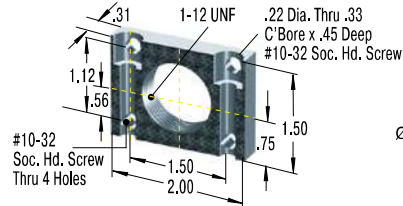

250-0044 Mounting Block

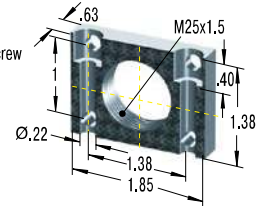

Additional accessories, mounting, installation ... starting on page 40.

Performance

TYPES	Max. Energy Capacity		Effective Weight					Hardness	Return Force min. lbs	Return Force max. lbs	Return Time s	1 Side Load Angle max. °	M	Weight lbs
	E ₃ in-lbs/cycle	E ₄ in-lbs/h	Soft-Contact We min. lbs	Soft-Contact We max. lbs	Self-Compensating We min. lbs	Self-Compensating We max. lbs								
SC190-0	225	300,000	-	-	1	9	-0	0.9	1.9	0.25	5	9/16-18 UNF / M14x1.5	0.176	
SC190-1	225	300,000	5	13	3	15	-1	0.9	1.9	0.25	5	9/16-18 UNF / M14x1.5	0.176	
SC190-2	225	300,000	12	36	8	40	-2	0.9	1.9	0.25	5	9/16-18 UNF / M14x1.5	0.176	
SC190-3	225	300,000	30	90	20	100	-3	0.9	1.9	0.25	5	9/16-18 UNF / M14x1.5	0.176	
SC190-4	225	300,000	75	200	50	225	-4	0.9	1.9	0.25	5	9/16-18 UNF / M14x1.5	0.176	
SC300-0	300	400,000	-	-	1	4	-0	1.05	2.15	0.1	5	3/4-16 UNF / M20x1.5	0.386	
SC300-1	300	400,000	5	15	3	18	-1	1.05	2.15	0.1	5	3/4-16 UNF / M20x1.5	0.386	
SC300-2	300	400,000	15	50	10	60	-2	1.05	2.15	0.1	5	3/4-16 UNF / M20x1.5	0.386	
SC300-3	300	400,000	50	150	30	180	-3	1.05	2.15	0.1	5	3/4-16 UNF / M20x1.5	0.386	
SC300-4	300	400,000	150	400	70	450	-4	1.05	2.15	0.1	5	3/4-16 UNF / M20x1.5	0.386	
SC650-0	650	600,000	-	-	5	31	-0	2.4	6.87	0.20	5	1-12 UNF / M25x1.5	0.739	
SC650-1	650	600,000	24	80	17	100	-1	2.4	6.87	0.20	5	1-12 UNF / M25x1.5	0.739	
SC650-2	650	600,000	75	250	50	300	-2	2.4	6.87	0.20	5	1-12 UNF / M25x1.5	0.335	
SC650-3	650	600,000	240	800	150	900	-3	2.4	6.87	0.20	5	1-12 UNF / M25x1.5	0.335	
SC650-4	650	600,000	800	2,400	450	2,600	-4	2.4	6.87	0.20	5	1-12 UNF / M25x1.5	0.335	
SC925-0	975	800,000	18	55	10	65	-0	2.4	7.4	0.40	5	1-12 UNF / M25x1.5	0.420	
SC925-1	975	800,000	50	160	30	200	-1	2.4	7.4	0.40	5	1-12 UNF / M25x1.5	0.420	
SC925-2	975	800,000	130	460	90	600	-2	2.4	7.4	0.40	5	1-12 UNF / M25x1.5	0.420	
SC925-3	975	800,000	400	1,350	250	1,600	-3	2.4	7.4	0.40	5	1-12 UNF / M25x1.5	0.420	